

Rohs

REV.	DESCRIPTION	DRAW.	DATE.

AUGO-BC-16-10PD310	16.00	14.40	11.20
AUGO-BC-16-9PD310	14.40	12.80	9.60
AUGO-BC-16-8PD310	12.80	11.20	8.00
AUGO-BC-16-7PD310	11.20	9.60	6.40
AUGO-BC-16-6PD310	9.60	8.00	4.80
AUGO-BC-16-5PD310	8.00	6.40	3.20
AUGO-BC-16-4PD310	6.40	4.80	0
AUGO-BC-16-3PD310	4.80	3.20	0
BE FILLED	DIMA	DIMB	DIMC

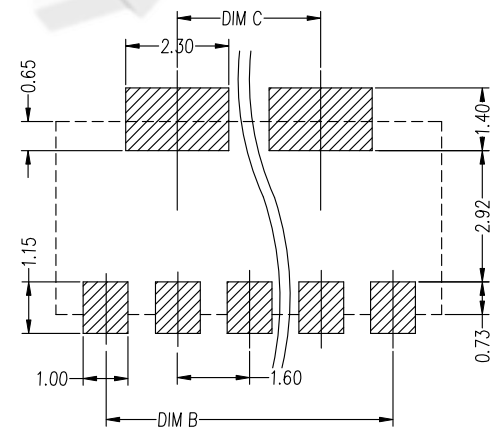
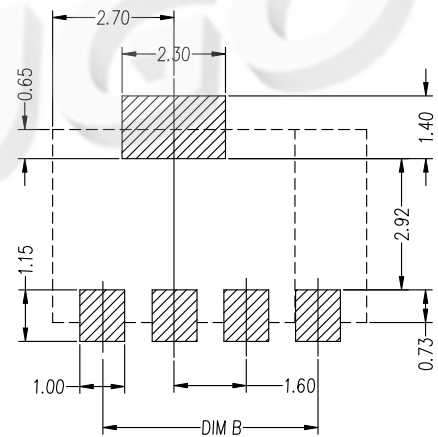
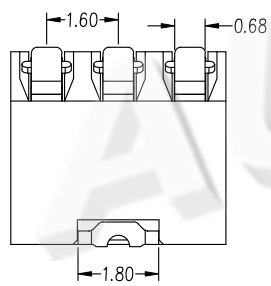
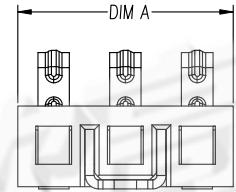
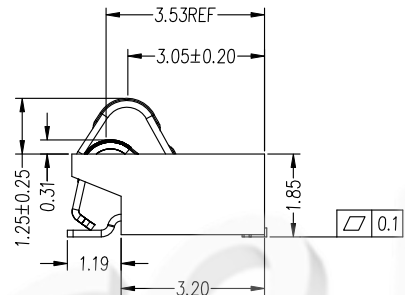
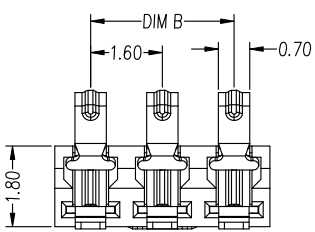
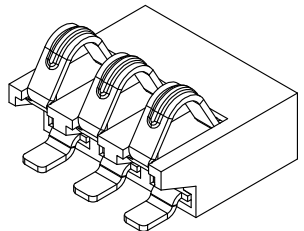
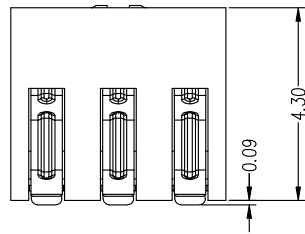

3&4PIN LAYOUT

5-10PIN LAYOUT

RECOMMENDED PCB LAYOUT

TOL: (±0.05)

-NOTES-

- Electrical:
Contact resistance: 50m ohms max.
Dielectric withstanding voltage: 250V RMS.
Insulation resistance: 100M ohms min.
- Mechanical:
MATE AND UNMATE FORCE:
MATE FORCE: 2.5kg MAX
UNMATE FORCE: 0.5kg MIN
Durability: 3000cycles MIN.
- Environment:
Operating Temperature: -55°to+105°.
- FINISH:
TERMINAL: GOLD Plated ALL Over NICKEL.
- MATERIAL:
5.1.Housing: HI-TEMP Plastic,UL94V-0,black;
5.2.Terminal: Copsy alloy,T=0.15mm
5.3 Stator: Brass T=0.20mm

AUGO

AUGO ELECTRONICS CO.,LTD.

COPYRIGHT RESERVED,PLEASE DO NOT COPY.

REV:	01
SIZE:	A4
SCALE: 1:1	UNIT: mm
SHEET: 1/1	

UNLESS OTHERWISE SPECIFIED,TOLERANCE:	
X.	±0.20
X.x	±0.15
X.xx	±0.10
ANGULAR	±2°

TITLE:	1.6 PITCH BATTERY CONNECTOR
PART NO.:	AUGO-BC-16H310

DESIGN	G.C.CHEN	DATE	
DRAWING	Y.C.ZHANG	DATE	
CHECK	D.J.WANG	DATE	
SCALE	1:1	PAGE	1 OF 1